

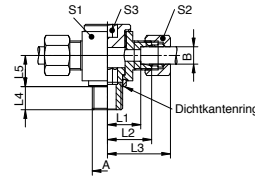

**DSVT-LR/SR**



Drosselfreie T-Schwenkverschraubung, Einschraubgewinde BSPP mit Dichtkantenring, leichte + schwere Reihe  
Choke-free T-banjo coupling, male thread BSPP with sealing ring, light and heavy duty series

Verschraubungsstutzen  
Body only

Reihe	A	B	PN / bar	L1 / mm	L2 / mm	L3 / mm	L4 / mm	L5 / mm	S1	S2	S3	Art.Nr.
L	G1/8	06	315	13.0	20.0	30.0	8.0	11.0	20	14	6	DSVT06L01
L	G1/4	08	315	16.0	23.0	33.0	12.0	16.0	25	17	8	DSVT08L02
L	G1/4	10	315	17.0	24.0	35.0	12.0	16.0	25	19	8	DSVT10L02
L	G3/8	12	315	19.0	26.0	37.0	12.0	18.0	30	22	10	DSVT12L03
L	G1/2	15	315	25.0	32.0	43.0	14.0	21.0	35	27	12	DSVT15L04
L	G1/2	18	315	25.0	32.5	44.5	14.0	23.0	35	32	12	DSVT18L04
L	G3/4	22	160	28.0	35.5	47.5	16.0	28.0	45	36	17	DSVT22L06
L	G1	28	160	32.0	39.5	53.5	18.0	32.0	50	41	22	DSVT28L08
L	G1 1/4	35	160	35.0	45.5	61.5	20.0	36.0	60	50	27	DSVT35L10
L	G1 1/2	42	160	40.0	51.0	67.0	22.0	41.0	70	60	32	DSVT42L12
S	G1/4	06	630	18.0	25.0	35.0	12.0	16.0	25	17	8	DSVT06S02
S	G1/4	08	630	18.0	25.0	35.0	12.0	16.0	25	19	8	DSVT08S02
S	G3/8	10	630	20.0	27.5	39.5	12.0	18.0	30	22	10	DSVT10S03
S	G3/8	12	630	20.0	27.5	39.5	12.0	18.0	30	24	10	DSVT12S03
S	G1/2	14	630	24.0	32.0	44.0	14.0	21.0	35	27	12	DSVT14S04
S	G1/2	16	400	22.0	30.5	43.5	14.0	23.0	35	30	12	DSVT16S04
S	G3/4	20	400	27.0	37.5	52.5	16.0	28.0	45	36	17	DSVT20S06
S	G1	25	400	31.0	43.0	59.0	18.0	32.0	50	46	22	DSVT25S08
S	G1 1/4	30	400	36.0	49.5	65.5	20.0	37.0	60	50	27	DSVT30S10
S	G1 1/2	38	250	41.0	57.0	76.0	22.0	42.0	70	60	32	DSVT38S12

Art.Nr.
XDSVT06L01
XDSVT08L02
XDSVT10L02
XDSVT12L03
XDSVT15L04
XDSVT18L04
XDSVT22L06
XDSVT28L08
XDSVT35L10
XDSVT42L12
XDSVT06S02
XDSVT08S02
XDSVT10S03
XDSVT12S03
XDSVT14S04
XDSVT16S04
XDSVT20S06
XDSVT25S08
XDSVT30S10
XDSVT38S12

**SWVE-LR/SR**

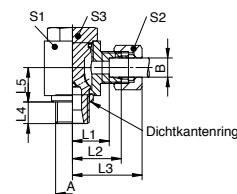

Winkel-Schwenkverschraubung, Einschraubgewinde BSPP mit Dichtkantenring, leichte + schwere Reihe  
Elbow banjo coupling, male thread BSPP with sealing ring, light and heavy duty series

Verschraubungsstutzen  
Body only

Reihe	A	B	PN / bar	L1 / mm	L2 / mm	L3 / mm	L4 / mm	L5 / mm	S1	S2	S3	Art.Nr.
L	G1/8	06	315	13.0	20.0	30.0	8.0	10.0	16	14	14	SWVE06L01
L	G1/4	08	315	14.0	21.0	31.0	10.0	14.0	20	17	19	SWVE08L02
L	G1/4	10	315	15.0	22.0	33.0	10.0	14.0	20	19	19	SWVE10L02
L	G3/8	12	315	18.0	25.0	36.0	10.0	16.0	25	22	22	SWVE12L03
L	G1/2	15	315	21.0	28.0	39.0	12.0	20.0	30	27	27	SWVE15L04
L	G1/2	18	315	21.0	28.5	40.5	12.0	22.0	30	32	27	SWVE18L04
L	G3/4	22	160	27.0	34.5	46.5	12.0	24.0	35	36	32	SWVE22L06
L	G1	28	160	31.0	38.5	52.5	12.0	30.0	45	41	41	SWVE28L08
L	G1 1/4	35	160	35.0	45.5	61.5	14.0	36.0	55	50	50	SWVE35L10
L	G1 1/2	42	160	40.0	51.0	67.0	14.0	41.0	65	60	60	SWVE42L12
S	G1/4	06	630	16.0	23.0	33.0	10.0	14.0	20	17	19	SWVE06S02
S	G1/4	08	630	16.0	23.0	33.0	10.0	14.0	20	19	19	SWVE08S02
S	G3/8	10	630	18.0	25.5	37.5	10.0	16.0	25	22	22	SWVE10S03
S	G3/8	12	630	18.0	25.5	37.5	10.0	16.0	25	24	22	SWVE12S03
S	G1/2	14	630	22.0	30.0	42.0	12.0	20.0	30	27	27	SWVE14S04
S	G1/2	16	400	21.0	29.5	42.5	12.0	22.0	30	30	27	SWVE16S04
S	G3/4	20	400	26.0	36.5	51.5	12.0	24.0	35	36	32	SWVE20S06
S	G1	25	400	31.0	43.0	59.0	12.0	30.0	45	46	41	SWVE25S08
S	G1 1/4	30	400	36.0	49.5	65.5	14.0	36.0	55	50	50	SWVE30S10
S	G1 1/2	38	250	41.0	57.0	76.0	14.0	41.0	65	60	60	SWVE38S12

Art.Nr.
XSWVE06L01
XSWVE08L02
XSWVE10L02
XSWVE12L03
XSWVE15L04
XSWVE18L04
XSWVE22L06
XSWVE28L08
XSWVE35L10
XSWVE42L12
XSWVE06S02
XSWVE08S02
XSWVE10S03
XSWVE12S03
XSWVE14S04
XSWVE16S04
XSWVE20S06
XSWVE25S08
XSWVE30S10
XSWVE38S12