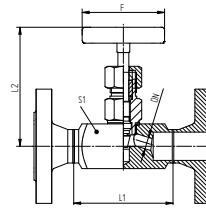
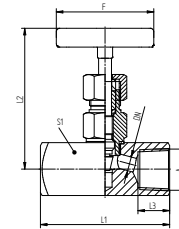

Fig. 110/F

Nadelventil mit DIN-Flanschen, Material: 1.4571

Needle valve with DIN-flanges, material: 1.4571

Figur	A	DN	PN / bar	L1 / mm	L2 / mm	S1	F / mm	Art.Nr.
Fig. 110/F	G1/2	7	40	60	90	30	63	10110F043PN40
Fig. 110/F	G3/4	9	40	75	100	35	63	10110F063PN40
Fig. 110/F	G1	12	40	100	110	45	90	10110F083PN40

Fig. 110/NPT

Nadelventil, beiderseits Innengewinde, Material: Stahl, 1.4571

Needle valve, both sides female thread, material: steel, 1.4571

Figur	A	DN	PN / bar	L1 / mm	L2 / mm	L3 / mm	S1	F / mm	Material	Art.Nr.
Fig. 110/NPT	1/4NPT	5	400	55	85	16.4	25	50	Stahl	101102022
Fig. 110/NPT	3/8NPT	6	400	60	85	17.4	25	50	Stahl	101102032
Fig. 110/NPT	1/2NPT	7	400	65	85	19.5	30	63	Stahl	101102042
Fig. 110/NPT	3/4NPT	9	200	85	105	23	35	63	Stahl	101102062
Fig. 110/NPT	1NPT	12	200	110	120	27	45	90	Stahl	101102082
Fig. 110/NPT	1/8NPT	4	400	50	85	11.6	25	50	1.4571	101102013
Fig. 110/NPT	1/4NPT	5	400	55	85	16.4	25	50	1.4571	101102023
Fig. 110/NPT	3/8NPT	6	400	60	85	17.4	25	50	1.4571	101102033
Fig. 110/NPT	1/2NPT	7	400	65	85	19.5	30	63	1.4571	101102043
Fig. 110/NPT	3/4NPT	9	200	85	105	23	35	63	1.4571	101102063
Fig. 110/NPT	1NPT	12	200	110	120	27	45	90	1.4571	101102083
Fig. 110/NPT	1 1/4NPT	15	160	120	155	28	60	100	1.4571	101102103
Fig. 110/NPT	1 1/2NPT	22	120	135	160	28	70	100	1.4571	101102123
Fig. 110/NPT	2NPT	24	120	135	160	28	70	100	1.4571	101102163