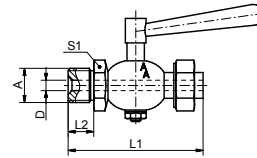



Fig. 182



Ablasshahn, Ausführung Außengewinde x Überwurfmutter und Lötrohr, Material: 1.4571

Drain cock, male thread x union nut and blowpipe, material: 1.4571

Figur	A	DN	PN / bar	°C	D	L1 / mm	L2 / mm	S1	Material	Art.Nr.
Fig. 182	G1/4	4	6	50	2.5	56	10	19	1.4571	10182023
Fig. 182	G3/8	6	6	50	4	62	10	22	1.4571	10182033
Fig. 182	G1/2	8	6	50	5	76	14	27	1.4571	10182043

Fig. 183

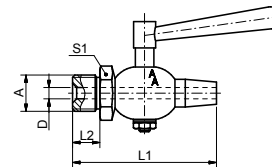

Ablasshahn, Ausführung Außengewinde x Probierspizze, Material: 1.4571

Drain cock, male thread x cone end, material: 1.4571

Figur	A	DN	PN / bar	°C	D	L1 / mm	L2 / mm	S1	Material	Art.Nr.
Fig. 183	G1/4	4	6	50	2.5	48	10	19	1.4571	10183023
Fig. 183	G3/8	6	6	50	4	56	10	22	1.4571	10183033
Fig. 183	G1/2	8	6	50	5	70	14	27	1.4571	10183043

Fig. 190

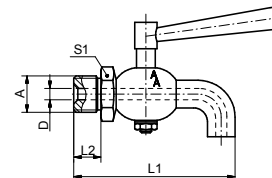

Ablasshahn, Ausführung Außengewinde x gebogener Auslauf, Material: 1.4571

Drain cock, male thread x bent outlet, material: 1.4571

Figur	A	DN	PN / bar	°C	D	L1 / mm	L2 / mm	S1	Material	Art.Nr.
Fig. 190	G1/8	4	6	50	2.5	55	10	19	1.4571	10190013
Fig. 190	G1/4	4	6	50	2.5	65	10	22	1.4571	10190023
Fig. 190	G3/8	6	6	50	4	71	12	22	1.4571	10190033
Fig. 190	G1/2	8	6	50	5	85	14	27	1.4571	10190043
Fig. 190	G3/4	12	6	50	8.5	104	16	32	1.4571	10190063
Fig. 190	G1	15	6	50	9	129	20	41	1.4571	10190083

Fig. 191

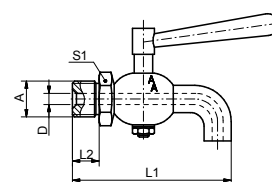

Ablasshahn, Ausführung Außengewinde x gebogener Auslauf, PTFE-dichtend, Material: 1.4571

Drain cock, male thread x bent outlet, PTFE sealed, Material: 1.4571

Figur	A	DN	PN / bar	°C	D	L1 / mm	L2 / mm	S1	Material	Art.Nr.
Fig. 191	G1/2	8	25	50	5	85	14	27	1.4571	10191043