

## Gerade, Winkel- und T-Verschraubungen

Straight, elbow and t-couplings

### G-L/S

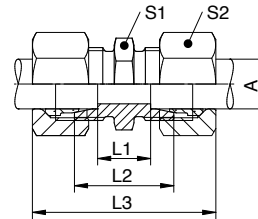

Gerade Verschraubung, leichte + schwere Reihe  
 Straight coupling, light and heavy duty series

Verschraubungsstutzen  
 Body only

Reihe	A	PN / bar	L1 / mm	L2 / mm	L3 / mm	S1	S2	Art.Nr.
L	06	315	10.0	24.0	44.0	12	14	G06L
L	08	315	11.0	25.0	45.0	14	17	G08L
L	10	315	13.0	27.0	49.0	17	19	G10L
L	12	315	14.0	28.0	50.0	19	22	G12L
L	15	315	16.0	30.0	52.0	24	27	G15L
L	18	315	16.0	31.0	55.0	27	32	G18L
L	22	160	20.0	35.0	59.0	32	36	G22L
L	28	160	21.0	36.0	64.0	41	41	G28L
L	35	160	20.0	41.0	73.0	46	50	G35L
L	42	160	21.0	43.0	75.0	55	60	G42L
S	06	630	16.0	30.0	50.0	14	17	G06S
S	08	630	18.0	32.0	52.0	17	19	G08S
S	10	630	17.0	32.0	56.0	19	22	G10S
S	12	630	19.0	34.0	58.0	22	24	G12S
S	14	630	22.0	38.0	62.0	24	27	G14S
S	16	400	21.0	38.0	64.0	27	30	G16S
S	20	400	23.0	44.0	74.0	32	36	G20S
S	25	400	26.0	50.0	82.0	41	46	G25S
S	30	400	27.0	54.0	86.0	46	50	G30S
S	38	250	29.0	61.0	99.0	55	60	G38S

Art.Nr.
XG06L
XG08L
XG10L
XG12L
XG15L
XG18L
XG22L
XG28L
XG35L
XG42L
XG06S
XG08S
XG10S
XG12S
XG14S
XG16S
XG20S
XG25S
XG30S
XG38S