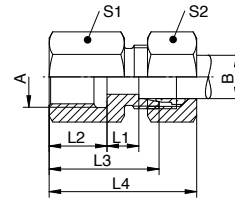

**GAI-LM/SM**

Gerade Aufschraubverschraubung, Aufschraubgewinde metrisch, leichte + schwere Reihe  
 Straight female coupling, female thread metric, light and heavy duty series

Verschraubungsstutzen  
 Body only

Reihe	A	B	PN / bar	L1 / mm	L2 / mm	L3 / mm	L4 / mm	S1	S2	Art.Nr.
L	M10x1	06	315	7.0	12.5	26.5	36.5	14	14	GAI06LM10
L	M12x1,5	08	315	7.0	17.0	31.0	41.0	17	17	GAI08LM12
L	M14x1,5	10	315	8.0	17.0	32.0	43.0	19	19	GAI10LM14
L	M16x1,5	10	315	8.0	17.0	32.0	43.0	22	19	GAI10LM16
L	M16x1,5	12	315	9.0	17.0	33.0	44.0	22	22	GAI12LM16
L	M18x1,5	15	315	11.0	17.0	35.0	46.0	24	27	GAI15LM18
L	M16x1,5	18	315	11.0	17.0	35.0	47.0	27	32	GAI18LM16
L	M22x1,5	18	315	10.5	19.0	37.0	49.0	30	32	GAI18LM22
L	M26x1,5	22	160	13.5	21.0	42.0	54.0	36	36	GAI22LM26
L	M33x2	28	160	13.5	24.0	45.0	59.0	41	41	GAI28LM33
L	M42x2	35	160	14.5	26.0	51.0	67.0	55	50	GAI35LM42
L	M48x2	42	160	14.0	28.0	53.0	69.0	60	60	GAI42LM48
S	M12x1,5	06	630	9.0	17.0	33.0	43.0	17	17	GAI06SM12
S	M14x1,5	08	630	9.0	17.0	33.0	43.0	19	19	GAI08SM14
S	M16x1,5	10	630	9.5	17.0	34.0	46.0	22	22	GAI10SM16
S	M18x1,5	12	630	10.5	17.0	35.0	47.0	24	24	GAI12SM18
S	M20x1,5	14	630	12.0	19.0	39.0	51.0	27	27	GAI14SM20
S	M22x1,5	16	400	11.5	19.0	39.0	52.0	30	30	GAI16SM22
S	M27x2	20	400	12.5	22.0	45.0	60.0	36	36	GAI20SM27
S	M33x2	25	400	13.0	24.0	49.0	65.0	41	46	GAI25SM33
S	M42x2	30	400	15.5	26.0	55.0	71.0	55	50	GAI30SM42
S	M48x2	38	250	15.0	28.0	59.0	78.0	60	60	GAI38SM48

Art.Nr.
XGAI06LM10
XGAI08LM12
XGAI10LM14
XGAI10LM16
XGAI12LM16
XGAI15LM18
XGAI18LM16
XGAI18LM22
XGAI22LM26
XGAI28LM33
XGAI35LM42
XGAI42LM48
XGAI06SM12
XGAI08SM14
XGAI10SM16
XGAI12SM18
XGAI14SM20
XGAI16SM22
XGAI20SM27
XGAI25SM33
XGAI30SM42
XGAI38SM48