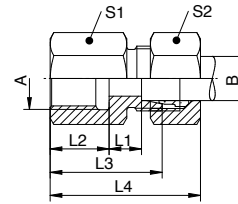

**GAI-S**

Gerade Aufschraubverschraubung, Aufschraubgewinde BSPP, schwere Reihe

Straight female coupling, female thread BSPP, heavy duty series

Verschraubungsstutzen

Body only

Reihe	A	B	PN / bar	L1 / mm	L2 / mm	L3 / mm	L4 / mm	S1	S2	Art.Nr.
S	G1/4	06	630	9.0	17.0	33.0	43.0	19	17	GAI06S02
S	G1/4	08	630	9.0	17.0	33.0	43.0	19	19	GAI08S02
S	G1/2	08	630	11.0	20.0	38.0	48.0	27	19	GAI08S04
S	G3/8	10	630	9.5	17.0	34.0	46.0	24	22	GAI10S03
S	G1/2	10	630	10.5	20.0	38.0	50.0	27	22	GAI10S04
S	G1/4	12	630	9.5	17.0	34.0	45.0	22	24	GAI12S02
S	G3/8	12	630	9.5	17.0	34.0	46.0	24	24	GAI12S03
S	G1/2	12	630	10.5	20.0	38.0	50.0	27	24	GAI12S04
S	G3/8	14	630	12.0	17.0	37.0	49.0	24	27	GAI14S03
S	G1/2	14	630	12.0	20.0	40.0	52.0	27	27	GAI14S04
S	G3/4	14	630	12.0	22.0	42.0	54.0	36	27	GAI14S06
S	G1/4	16	400	11.5	17.0	37.0	50.0	27	30	GAI16S02
S	G3/8	16	400	11.5	17.0	37.0	50.0	27	30	GAI16S03
S	G1/2	16	400	11.5	20.0	40.0	53.0	30	30	GAI16S04
S	G1/2	20	400	12.5	20.0	43.0	58.0	32	36	GAI20S04
S	G3/4	20	400	12.5	22.0	45.0	60.0	36	36	GAI20S06
S	G1	20	400	13.0	24.5	48.0	63.0	41	36	GAI20S08
S	G1	25	400	13.0	24.5	49.5	65.5	41	46	GAI25S08
S	G1 1/4	30	400	15.5	26.5	55.5	71.5	55	50	GAI30S10
S	G1 1/2	38	250	15.0	28.5	59.5	78.5	60	60	GAI38S12

Art.Nr.
XGAI06S02
XGAI08S02
XGAI08S04
XGAI10S03
XGAI10S04
XGAI12S02
XGAI12S03
XGAI12S04
XGAI14S03
XGAI14S04
XGAI14S06
XGAI16S02
XGAI16S03
XGAI16S04
XGAI20S04
XGAI20S06
XGAI20S08
XGAI25S08
XGAI30S10
XGAI38S12