



## Steckkupplungen FH-VA

### Quick-Release Couplings FH-VA

Werkstoff: Edelstahl 1.4104

Betriebsdruck: P max 25MPa (250 bar)

Berstdruck: P gekuppelt 1000 bar

P Muffe 1000 bar

Material: Stainless steel 1.4104

Working pressure: P max 25MPa (250 bar)

Bursting pressure: P coupled 1000 bar

P female coupling 1000 bar

### Kupplungsmuffe

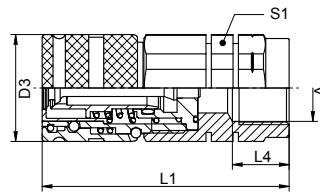

Figur	A	D3	L1 / mm	L4 / mm	S1	Art.Nr.
FH-VA-Muffe	G1/2	32	74.0	14.0	30	FH101IGF08VA
FH-VA-Muffe	G1/2	38	84.0	14.5	36	FH121IGF08VA
FH-VA-Muffe	G3/4	38	84.0	20.4	36	FH121IGF12VA

### Kupplungsstecker

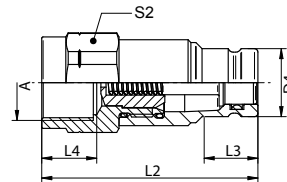

Figur	A	D4	L2 / mm	L3 / mm	L4 / mm	S2	Art.Nr.
FH-VA-Stecker	G1/2	19.79	62.9	15.6	14.0	27	FH102IGF08VA
FH-VA-Stecker	G1/2	24.58	71.0	16.9	14.5	36	FH122IGF08VA
FH-VA-Stecker	G3/4	24.58	71.0	16.9	20.4	36	FH122IGF12VA