

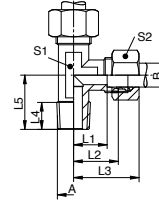

LE-LR/SR-NPT



L-Einschraubverschraubung, Einschraubgewinde NPT, leichte + schwere Reihe

L-male stud coupling, male thread NPT, light and heavy duty series

Verschraubungsstutzen

Body only

Reihe	A	B	PN / bar	L1 / mm	L2 / mm	L3 / mm	L4 / mm	L5 / mm	S1	S2	Art.Nr.
L	1/8NPT	06	315	12.0	19.0	29.0	10.0	20.0	12	14	LE06LN01
L	1/4NPT	08	315	14.0	21.0	31.0	15.0	26.0	12	17	LE08LN02
L	1/4NPT	10	315	15.0	22.0	33.0	15.0	27.0	14	19	LE10LN02
L	3/8NPT	12	315	17.0	24.0	35.0	15.0	28.0	17	22	LE12LN03
L	1/2NPT	15	315	21.0	28.0	39.0	20.0	34.0	19	27	LE15LN04
L	1/2NPT	18	315	23.5	31.0	43.0	20.0	36.0	24	32	LE18LN04
L	3/4NPT	22	160	27.5	35.0	47.0	20.0	42.0	27	36	LE22LN06
L	1NPT	28	160	30.5	38.0	52.0	25.0	48.0	36	41	LE28LN08
L	1 1/4NPT	35	160	34.5	45.0	61.0	26.0	54.0	41	50	LE35LN10
L	1 1/2NPT	42	160	40.0	51.0	67.0	26.0	61.0	50	60	LE42LN12
S	1/4NPT	06	630	16.0	23.0	33.0	15.0	26.0	12	17	LE06SN02
S	1/4NPT	08	630	17.0	24.0	34.0	15.0	27.0	14	19	LE08SN02
S	3/8NPT	10	630	17.5	25.0	37.0	15.0	28.0	17	22	LE10SN03
S	3/8NPT	12	630	22.5	29.0	41.0	15.0	28.0	17	24	LE12SN03
S	1/2NPT	14	630	22.0	30.0	42.0	20.0	34.0	19	27	LE14SN04
S	1/2NPT	16	400	24.5	33.0	46.0	20.0	36.0	24	30	LE16SN04
S	3/4NPT	20	400	26.5	37.0	52.0	20.0	42.0	27	36	LE20SN06
S	1NPT	25	400	30.0	42.0	58.0	25.0	48.0	36	46	LE25SN08
S	1 1/4NPT	30	400	35.5	49.0	65.0	26.0	54.0	41	50	LE30SN10
S	1 1/2NPT	38	250	41.0	57.0	76.0	26.0	61.0	50	60	LE38SN12

Art.Nr.
XLE06LN01
XLE08LN02
XLE10LN02
XLE12LN03
XLE15LN04
XLE18LN04
XLE22LN06
XLE28LN08
XLE35LN10
XLE42LN12
XLE06SN02
XLE08SN02
XLE10SN03
XLE12SN03
XLE14SN04
XLE16SN04
XLE20SN06
XLE25SN08
XLE30SN10
XLE38SN12