

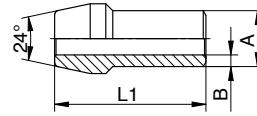

SKM-L/S



Schweißkegel metallisch dichtend, leichte + schwere Reihe

Welded nipple metallic sealed, light and heavy duty series

Reihe	A	B	PN / bar	L1 / mm	Art.Nr.
L/S	06	1,0	466	31.0	SKM06X1.0
L/S	06	1,5	539	31.0	SKM06X1.5
L/S	08	1,0	350	31.0	SKM08X1.0
L/S	08	1,5	424	31.0	SKM08X1.5
L/S	08	2,0	539	31.0	SKM08X2
L/S	10	1,0	242	32.5	SKM10X1.0
L/S	10	1,5	349	32.5	SKM10X1.5
L/S	10	2,0	447	32.5	SKM10X2
L/S	12	1,5	297	32.5	SKM12X1.5
L/S	12	2,0	383	32.5	SKM12X2
L/S	12	2,5	463	32.5	SKM12X2.5
L	15	1,5	280	34.0	SKM15X1.5
L	15	2,0	315	34.0	SKM15X2.0
L	18	1,5	230	35.5	SKM18X1.5
L	18	2,0	315	35.5	SKM18X2
L	22	2,0	160	38.5	SKM22X2
L	22	2,5	160	38.5	SKM22X2.5
L	28	2,5	160	41.5	SKM28X2.5
L	28	3,0	160	41.5	SKM28X3
L	28	3,5	160	41.5	SKM28X3.5
L	35	3,0	160	47.5	SKM35X3
L	35	3,5	160	47.5	SKM35X3.5
L	35	4,0	160	47.5	SKM35X4
L	42	3,0	160	47.5	SKM42X3.0
L	42	4,0	160	47.5	SKM42X4.0
S	14	2,0	334	38.5	SKM14X2
S	16	2,0	297	39.0	SKM16X2
S	16	2,5	362	39.0	SKM16X2.5
S	16	3,0	400	39.0	SKM16X3
S	20	2,0	242	45.0	SKM20X2
S	20	2,5	297	45.0	SKM20X2.5
S	20	3,0	349	45.0	SKM20X3
S	20	4,0	400	45.0	SKM20X4
S	25	3,0	286	49.5	SKM25X3
S	25	3,5	328	49.5	SKM25X3.5
S	25	4,0	369	49.5	SKM25X4
S	30	3,0	242	52.0	SKM30X3
S	30	4,0	314	52.0	SKM30X4
S	30	6,0	400	52.0	SKM30X6
S	38	4,0	250	56.5	SKM38X4
S	38	5,0	250	56.5	SKM38X5