

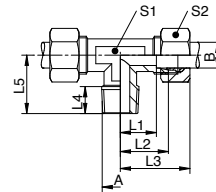

## T-Einschraubverschraubungen

### T-male stud couplings

#### TE-LR/SR-KEG



T-Einschraubverschraubung, Einschraubgewinde BSPT, leichte + schwere Reihe

T-male stud coupling, male thread BSPT, light and heavy duty series

Verschraubungsstutzen

Body only

Reihe	A	B	PN / bar	L1 / mm	L2 / mm	L3 / mm	L4 / mm	L5 / mm	S1	S2	Art.Nr.
L	R1/8keg	06	315	12.0	19.0	29.0	8.0	20.0	12	14	TE06L01
L	R1/4keg	06	315	14.0	21.0	31.0	12.0	26.0	12	14	TE06L02
L	R1/4keg	08	315	14.0	21.0	31.0	12.0	26.0	12	17	TE08L02
L	R3/8keg	08	315	17.0	24.0	34.0	12.0	28.0	17	17	TE08L03
L	R1/2keg	08	315	20.0	27.0	37.0	14.0	32.0	17	17	TE08L04
L	R1/4keg	10	315	15.0	22.0	33.0	12.0	27.0	14	19	TE10L02
L	R3/8keg	10	315	17.0	24.0	35.0	12.0	28.0	17	19	TE10L03
L	R1/2keg	10	315	21.0	28.0	39.0	14.0	32.0	17	19	TE10L04
L	R1/4keg	12	315	17.0	24.0	35.0	12.0	28.0	17	22	TE12L02
L	R3/8keg	12	315	17.0	24.0	35.0	12.0	28.0	17	22	TE12L03
L	R3/8keg	15	315	21.0	28.0	39.0	12.0	34.0	19	27	TE15L03
L	R1/2keg	15	315	21.0	28.0	39.0	14.0	34.0	19	27	TE15L04
L	R3/8keg	18	315	22.5	30.0	42.0	12.0	35.0	24	32	TE18L03
L	R1/2keg	18	315	23.5	31.0	43.0	14.0	36.0	24	32	TE18L04
S	R1/4keg	06	630	16.0	23.0	33.0	12.0	26.0	12	17	TE06S02
S	R1/4keg	08	630	17.0	24.0	34.0	12.0	27.0	14	19	TE08S02
S	R3/8keg	10	630	17.5	25.0	37.0	12.0	28.0	17	22	TE10S03
S	R1/2keg	12	630	22.5	30.0	42.0	14.0	32.0	17	24	TE12S04
S	R1/2keg	14	630	22.0	30.0	42.0	14.0	32.0	17	27	TE14S04
S	R1/2keg	16	400	24.5	33.0	46.0	14.0	32.0	24	30	TE16S04

Art.Nr.
XTE06L01
XTE06L02
XTE08L02
XTE08L03
XTE08L04
XTE10L02
XTE10L03
XTE10L04
XTE12L02
XTE12L03
XTE15L03
XTE15L04
XTE18L03
XTE18L04
XTE06S02
XTE08S02
XTE10S03
XTE12S04
XTE14S04
XTE16S04

#### TE-LR/SR

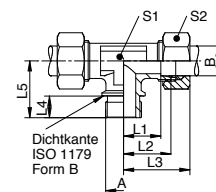

T-Einschraubverschraubung, Einschraubgewinde BSPP mit Dichtkante Form B, leichte + schwere Reihe

T-male stud coupling, male thread BSPP with sealing edge form B, light and heavy duty series

Verschraubungsstutzen

Body only

Reihe	A	B	PN / bar	L1 / mm	L2 / mm	L3 / mm	L4 / mm	L5 / mm	S1	S2	Art.Nr.
L	G3/4	22	160	27.5	35.0	47.0	16.0	26.0	27	36	TE22L06
L	G1	28	160	30.5	38.0	52.0	18.0	30.0	36	41	TE28L08
L	G1 1/4	35	160	34.5	45.0	61.0	20.0	34.0	41	50	TE35L10
L	G1 1/2	42	160	40.0	51.0	67.0	22.0	39.0	50	60	TE42L12
S	G3/4	20	400	26.5	37.0	52.0	16.0	26.0	27	36	TE20S06
S	G1	25	400	30.0	42.0	58.0	18.0	30.0	36	46	TE25S08
S	G1 1/4	30	400	35.5	49.0	65.0	20.0	34.0	41	50	TE30S10
S	G1 1/2	38	250	41.0	55.0	74.0	22.0	39.0	50	60	TE38S12

Art.Nr.
XTE22L06
XTE28L08
XTE35L10
XTE42L12
XTE20S06
XTE25S08
XTE30S10
XTE38S12